

EASTMAN®

BLUE STREAK® II Model 629X

BRUTE Model 627X

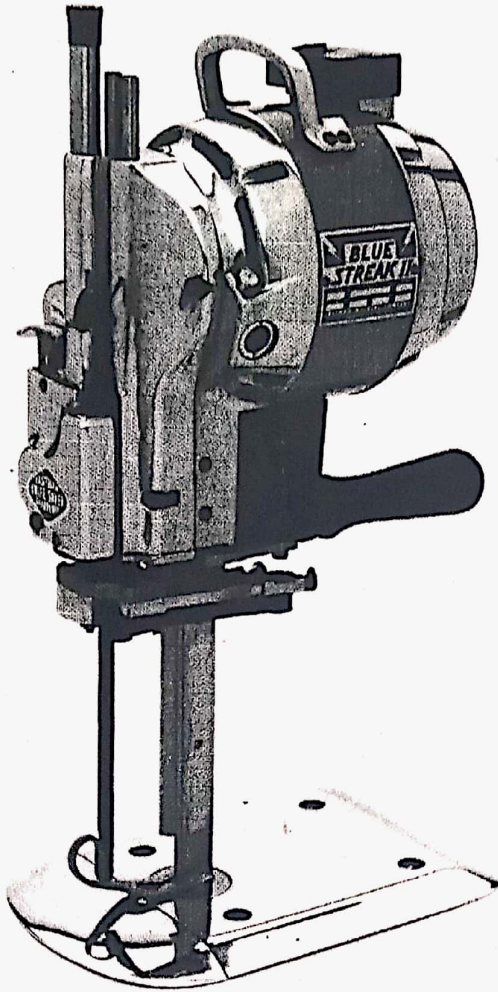

Instruction Manual and Parts List

Blue Streak II Model 629X

Brute Model 627X

Serial # _____

⚠ WARNING

This machine is equipped with a very sharp knife. Keep hands, arms, and hair away from the knife area at all times.

Misuse of this machine or failure to follow all safety instructions on this machine and in the instruction manual may result in serious personal injuries.

**Eastmanmachine
COMPANY**

779 Washington St., Buffalo, N.Y. 14203-1396 U.S.A. • (716) 856-2200 • Fax (716) 856-1140 or (716) 856-2068

Manufacturers of Eastman Cloth Cutting and Cloth Spreading Machines

Website: www.EastmanCuts.com

Form C-1555

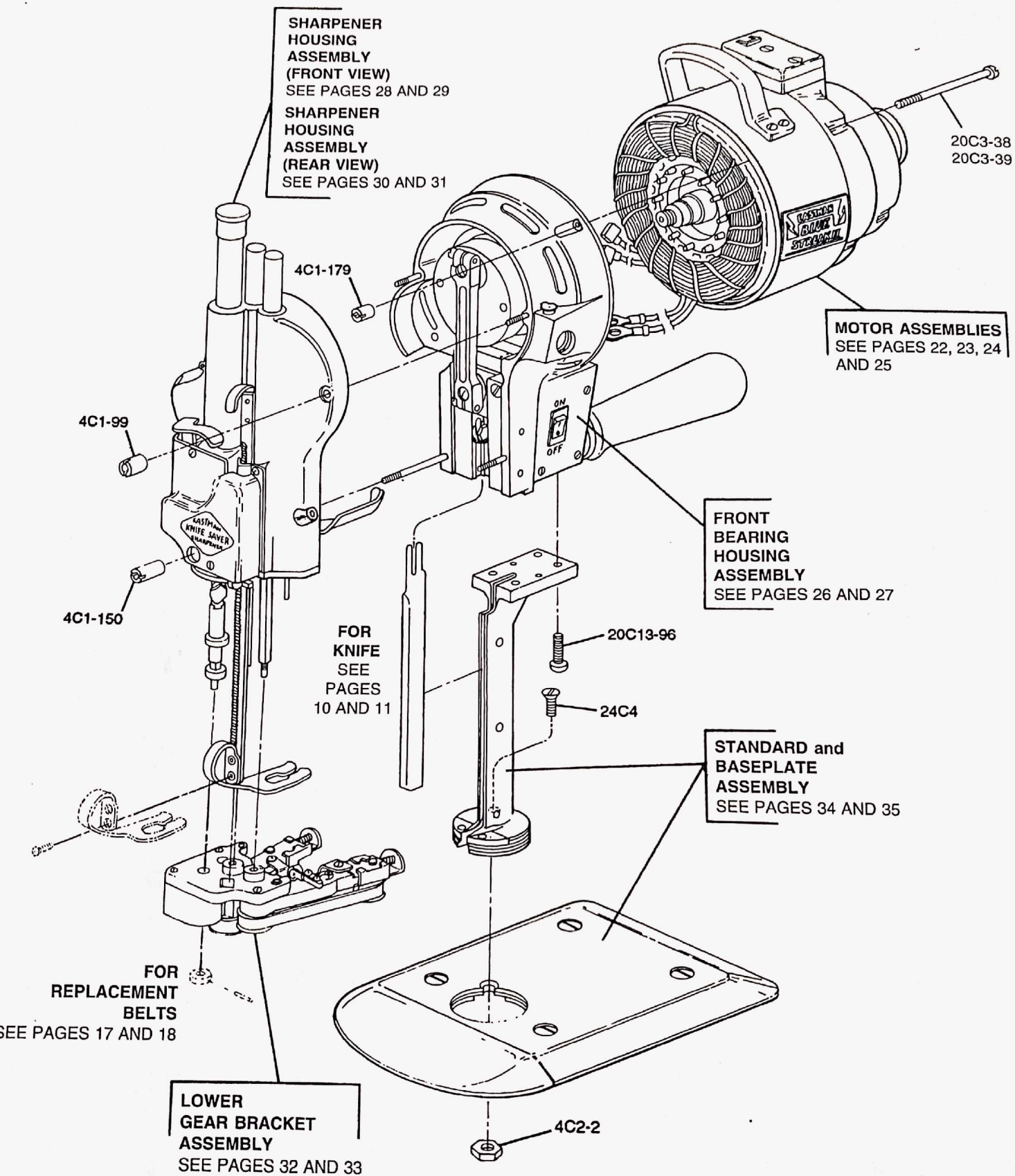

Figure 20. Standard and Baseplate Assembly (Exploded View)

Eastman machine
COMPANY

Single-Phase Motor Assemblies (Single- and Dual-Speed)

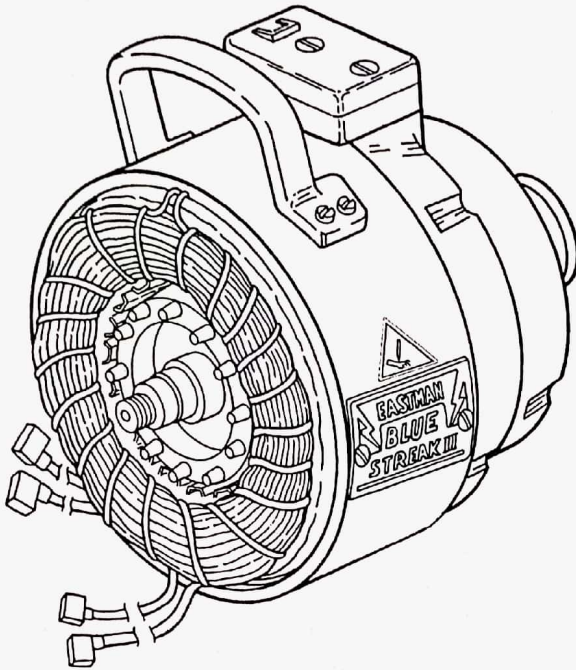

Figure 21. Single-Phase Motor Assembly
(Assembled View)

Note: Please specify model and serial number of machine when ordering parts.

Part No.	No. Req'd	Description
4C1-145	1 1	Shaft Lock Nut
4C2-87	1 1	Nut, Clutch
8C5-10	1 1	Automatic Switch Insulation
8C12-4	2 2	Lead Wire Insulation
10C1-41	1 1	Rotor Fan
12C1-12	1 1	Loading Spring Washer
12C1-32	1 1	Lock Washer
13C1-9	1 1	Turning Knob
18C6-16	1 1	Retaining Ring
22C1-24	1 1	Carrying Handle
30C1-8	1 1	Dust Cap
34C1-51	1 1	Clutch Spring
47C4-79	1 1	Terminal
47C4-80	1 1	Terminal

Part No.	No. Req'd	Description
53C7-35	1 1	Fan Cover
73C7-121	1 1	Terminal Wire Tubing
90C1-146	1 1	Rear Bearing Housing
90C6-46	1 1	Rear Ball Bearing
236C1-177	1 1	Label, Warning
254C1	1 1	Cable Tie, 4"
300C12-6	4 4	Screw, Round Head
301C8-1	3 3	Screw, 4-40 x 1/2 Fillister Head
301C12-3	2 2	Screw, 8-32 x 3/8 Fillister Head
305C8-1	10 10	Screw, Binding Head
305C10-1	1 1	Screw, Binding Head
513C3-241	0 1	Rotor and Shaft
513C3-240	1 0	Rotor and Shaft
514C7-109	1 0	Stator with Band 110V 60 Hz. 3600 R.P.M.
514C7-110	1 0	Stator with Band 220V 60 Hz. 3600 R.P.M.
514C7-113	1 0	Stator with Band 220V 50 Hz. 3000 R.P.M.
514C7-114	1 0	Stator with Band 110V 60 Hz. 1800/3600 R.P.M.
514C7-115	1 0	Stator with Band 220V 60 Hz. 1800/3000 R.P.M.
514C7-117	1 0	Stator with Band 110V 50 Hz. 3000 R.P.M.
514C7-118	1 0	Stator with Band 220V 50 Hz. 1500/3000 R.P.M.
514C7-119	1 0	Stator with Band 110V 50 Hz. 1500 R.P.M.
514C7-120	0 1	Stator with Band 42V 50 Hz. 3000 R.P.M.
514C7-121	0 1	Stator with Band 42V 50 Hz. 1500/3000 R.P.M.
514C7-122	0 1	Stator with Band 100V 60 Hz. 3600 R.P.M.
514C7-123	0 1	Stator with Band 100V 60 Hz. 1800/ 3600 R.P.M.
514C7-124	0 1	Stator with Band 100V 50 Hz. 3000 R.P.M.
514C7-126	0 1	Stator with Band 110V 50 Hz. 1500/3000 R.P.M.
514C7-127	0 1	Stator with Band 110V 60 Hz. 3600 R.P.M.
514C7-128	0 1	Stator with Band 110V 60 Hz. 1800 R.P.M.
514C7-129	0 1	Stator with Band 110V 60 Hz. 1500/3000 R.P.M.
514C7-137	0 1	Stator with Band 220V 50 Hz. 3000 R.P.M.
514C7-138	0 1	Stator with Band 220V 50 Hz. 1500 R.P.M.
514C7-139	0 1	Stator with Band 220V 50 Hz. 1500/3000 R.P.M.
514C7-140	0 1	Stator with Band 220V 60 Hz. 3600 R.P.M.
514C7-141	0 1	Stator with Band 220V 60 Hz. 1800 R.P.M.
514C7-142	0 1	Stator with Band 220V 60 Hz. 1800/3600 R.P.M.
514C7-156	1 0	Stator with Band 100V 60 Hz. 1800/ 3600 R.P.M.
514C7-165	1 0	Stator with Band 42V 50 Hz. 3000 R.P.M.
514C7-174	1 0	Stator with Band 220V 60 Hz. 1800 R.P.M.
514C7-193	0 1	Stator with Band 100V 55 Hz. 3300 R.P.M.
514C7-194	0 1	Stator with Band 100V 55 Hz. 1725/3300 R.P.M.
514C7-195	1 0	Stator with Band 100V 55 Hz. 3300 R.P.M.
514C7-196	1 0	Stator with Band 100V 55 Hz. 1725/3300 R.P.M.
597C2-14	1 1	Cutout Assy 60 Cycle 3600 R.P.M.
597C2-15	1 1	Cutout Assy 50 Cycle 3000 R.P.M.
597C2-16	1 1	Cutout Assy 60 Cycle 1800 R.P.M.
597C2-17	1 1	Cutout Assy 50 Cycle 1500 R.P.M.
597C2-18	1 1	Cutout Assy 50 Cycle 1500/3000 R.P.M.
597C2-25	1 1	Cutout Assy 60 Cycle 1800/3600 R.P.M.
783C1-3	1 1	Grounding Wire Assy.

**STATOR WITH BAND
SINGLE-PHASE SINGLE-SPEED**
(See Page 22 for Ratings)

514C7-109	514C7-128
514C7-110	514C7-137
514C7-113	514C7-138
514C7-117	514C7-140
514C7-119	514C7-141
514C7-120	514C7-164
514C7-121	514C7-174
514C7-122	514C7-193
514C7-124	514C7-195
514C7-127	

**STATOR WITH BAND
SINGLE-PHASE DUAL-SPEED**
(See Page 22 for Ratings)

514C7-114	514C7-139
514C7-115	514C7-142
514C7-118	514C7-156
514C7-123	514C7-194
514C7-126	514C7-196
514C7-129	

WARNING
Attach ground wire to ground terminal "E" on Terminal block. Failure to ground Terminal block may result in electrocution or other serious personal injuries.

Note: L.H. indicates left-hand thread. All others are right-hand.

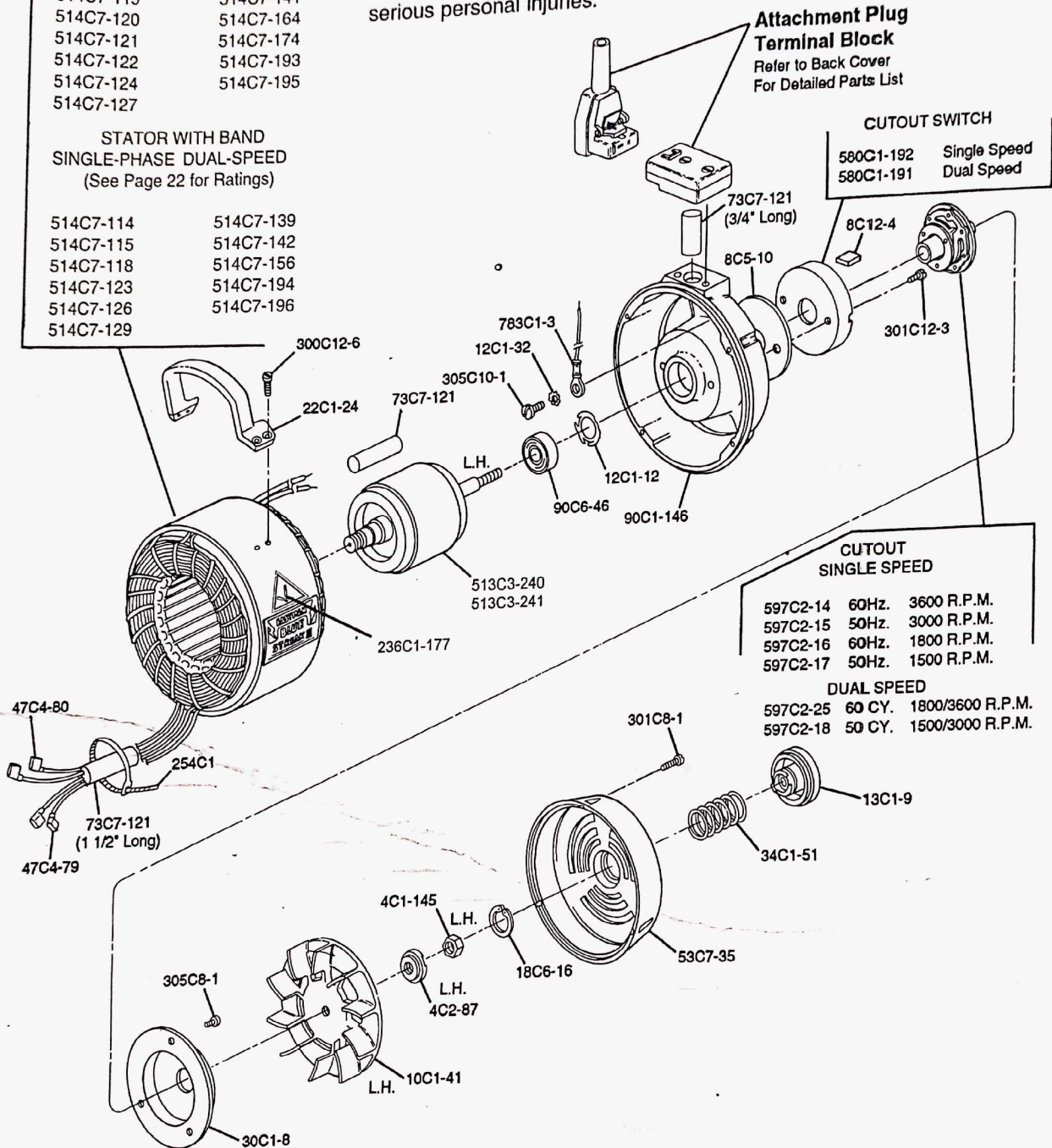

Figure 22. Single/Dual-Phase Motor Assembly (Exploded View)

Eastman
machine
COMPANY

Three-Phase Motor Assemblies

(Single- and Dual-Speed)

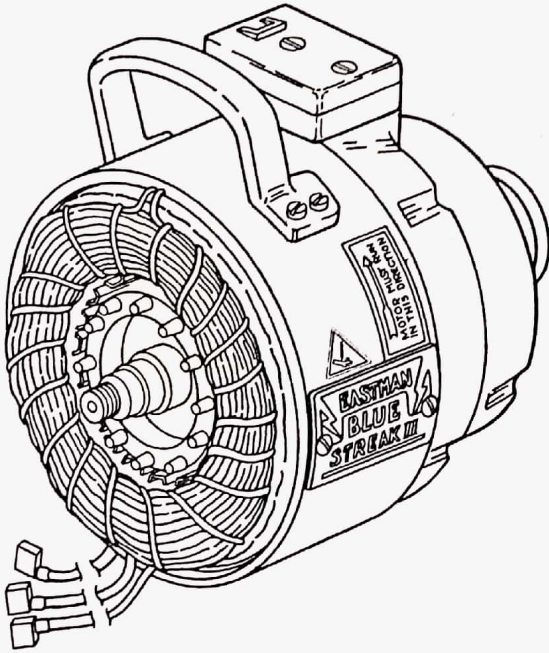

Figure 23. Three-Phase Motor Assembly
(Assembled View)

Note: Please specify model and serial number of machine when ordering parts.

Part No.	No. Req'd	Description
1C4-8	1 1	Sleeve, Cutout
4C1-145	1 1	Shaft Lock Nut
4C2-87	1 1	Nut, Clutch
10C1-41	1 1	Rotor Fan
12C1-12	1 1	Loading Spring Washer
12C1-32	1 1	Lock Washer
13C1-9	1 1	Turning Knob
18C8-16	1 1	Retaining Ring
22C1-24	0 1	Handle, Carrying
30C1-8	1 1	Dust Cap
34C1-51	1 1	Clutch Spring
53C7-35	1 1	Fan Cover
67C1-10	1 1	Cutout Mount
73C7-121	1 1	Tubing, Terminal Wire
79C2-81	1 1	Plate, Direction Arrow
90C1-146	1 1	Rear Bearing Housing
90C6-46	1 1	Rear Ball Bearing
199C1-23	3 3	Wire Lug
236C1-177	1 1	Label, Warning
254C1	1 1	Cable Tie
300C12-3	2 2	Screw, 8-32 x 3/8 Round Hd.
300C12-6	4 4	Screw, Round Hd.
301C8-1	3 3	Screw, 4-40 x 1/2 Phillips Hd.
305C8-1	10 10	Screw, Binding Hd.
305C10-1	1 1	Screw, Binding Hd.
513C3-241	0 1	Rotor and Shaft
513C3-240	1 0	Rotor and Shaft
514C7-116	1 0	Stator with Band 100V 60 Hz. 3600 R.P.M.
514C7-130	0 1	Stator with Band 125V 50 Hz. 3000 R.P.M.
514C7-135	0 1	Stator with Band 208V 60 Hz. 3600 R.P.M.
514C7-143	0 1	Stator with Band 220V 50 Hz. 3000 R.P.M.
514C7-144	0 1	Stator with Band 220V 50 Hz. 1500 R.P.M.
514C7-145	0 1	Stator with Band 220V 50 Hz. 1500/3000 R.P.M.
514C7-146	0 1	Stator with Band 220V 60 Hz. 3600 R.P.M.
514C7-147	0 1	Stator with Band 220V 60 Hz. 1800 R.P.M.
514C7-148	0 1	Stator with Band 220V 60 Hz. 1800/3600 R.P.M.
514C7-151	0 1	Stator with Band 380V 50 Hz. 3000 R.P.M.
514C7-152	0 1	Stator with Band 380V 50 Hz. 1500 R.P.M.
514C7-155	1 0	Stator with Band 220V 60 Hz. 3600 R.P.M.
514C7-157	1 0	Stator with Band 220V 50Hz. 3000 R.P.M.
514C7-158	1 0	Stator with Band 220V 60Hz. 1800/3600 R.P.M.
514C7-159	0 1	Stator with Band 110V 50 Hz. 3000 R.P.M.
514C7-161	1 0	Stator with Band 380V 50 Hz. 3000 R.P.M.
514C7-164	0 1	Stator with Band 220/380V 50 Hz. 3000 R.P.M.
514C7-166	1 0	Stator with Band 220/380V 50 Hz. 3000 R.P.M.
514C7-168	1 0	Stator with Band 220V 60 Hz. 1800 R.P.M.
514C7-171	1 0	Stator with Band 380V 50Hz. 1500/ 3000 R.P.M.
514C7-172	1 0	Stator with Band 380V 50 Hz. 1500 R.P.M.
514C7-173	1 0	Stator with Band 220V 50Hz. 1500/ 3000 R.P.M.
783C1-3	1 1	Ground Wire Assy.

**STATOR WITH BAND
THREE-PHASE SINGLE-SPEED**
(See Page 24 for Ratings)

- | | |
|-----------|-----------|
| 514C7-116 | 514C7-155 |
| 514C7-130 | 514C7-157 |
| 514C7-135 | 514C7-159 |
| 514C7-143 | 514C7-164 |
| 514C7-144 | 514C7-166 |
| 514C7-146 | 514C7-168 |
| 514C7-147 | 514C7-172 |
| 514C7-151 | 514C7-161 |
| 514C7-152 | |

**STATOR WITH BAND
THREE-PHASE DUAL-SPEED**
(See Page 24 for Ratings)

- | |
|-----------|
| 514C7-145 |
| 514C7-148 |
| 514C7-158 |
| 514C7-171 |
| 514C7-173 |

⚠ WARNING

Attach ground wire to ground terminal "E" on Terminal block. Failure to ground Terminal block may result in electrocution or other serious personal injuries.

Note: L.H. indicates left-hand thread. All others are right-hand.

**Attachment Plug
Terminal Block**
Refer to Back Cover
For Detailed Parts List

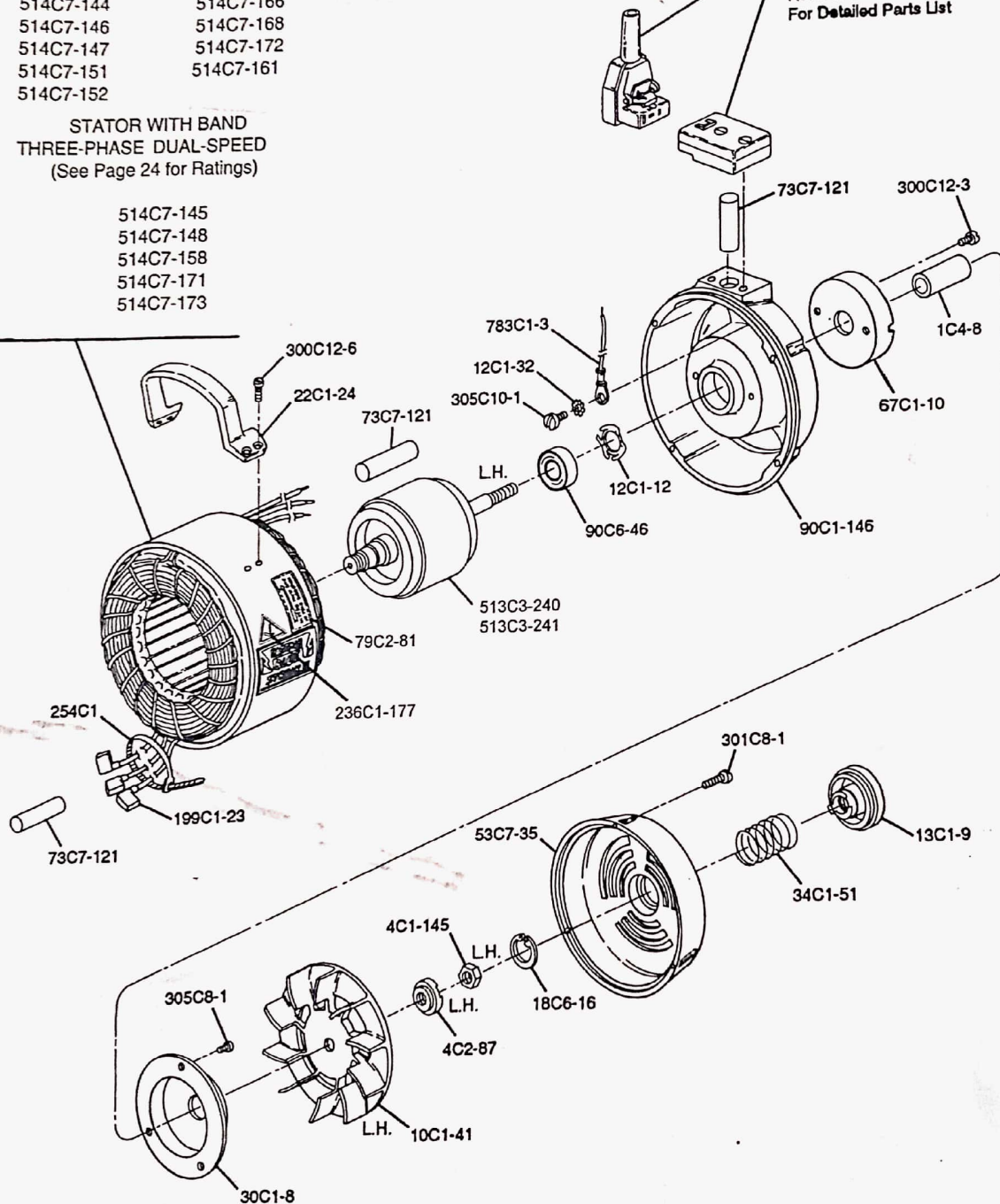

Figure 24. Three-Phase Motor Assembly (Exploded View)

**Eastmanmachine
COMPANY**

Front Bearing Housing (90C2-162) with Oiler Assembly

Note: Please specify model and serial number of machine when ordering parts.

Part No.	No. Req'd	Description
4C1-111	1	Operating Handle Lock Nut
4C1-132	1	Crank Ball Bearing Lock Nut
4C1-190	1	Lock Nut for Shaft
4C2-91	3	Nut for Guide Screw
4C2-110	1	Stop Nut
4C3-8	3	Guide Adjustment Nut
11C12-92	1	Shaft for Ball Bearing
12C1-21	2	Shakeproof Washer
12C1-24	1	Knife Lock Washer
12C10-2	3	Washer
12C15-14	6	Guide Washer
12C15-53	1	Connecting Rod Washer
15C13-23	2	Stud, Upper
15C13-34	1	Stud, Lower L.H. Mounting
15C13-39	1	Stud, Lower R.H. Mounting
17C4-6	1	Wrist Pin
18C6-79	1	Lock Ring
18C6-80	1	O-Ring
20C5-17	2	Connecting Rod Clamp Screw
20C12-62	1	Front Housing Plug Screw
20C12-79	1	Screw for Handle Bracket
24C1-3	1	Knife Lock Bolt
34C10-142	1	Spring for Capacitor
52C5-194	1	Switch Plate (Dual-Speed Three-Phase)
52C5-235	1	Switch Plate (Single-Speed)
52C5-236	1	Switch Plate (Dual-Speed Single-Phase)
53C2-111	1	Switch Cover
53C6-2	1	Oiler Tube Cover
53C11-91	1	Capacitor Cover
54C4-32	1	Wrist Pin Plug

Part No.	No. Req'd	Description
62C1-140	1	Handle Bracket
71C3-18	1	Front Ball Bearing Retainer
72C4-28	1	Oil Hole Cover
73C7-203	1	Oil Tube, Clear
73C7-204	1	Oiler Tube
85C1-52	1	Crank 1-1/8 Stroke
85C1-46	1	Crank 1-1/4 Stroke
85C1-45	1	Crank 1-1/2 Stroke
85C1-44	1	Crank 1-3/4 Stroke
90C2-162	1	Front Bearing Housing
90C6-38	1	Front Ball Bearing
90C6-46	1	Seated Crank Ball Bearing
91C4-25	2	Rivet Crosshead
141C1-46	1	Gauge, Clear
191C1-21	1	Cross Head Felt pad
191C1-38	1	Wrist Pin Felt Pad
191C1-42	1	Oil Felt Wicking, Long
191C1-43	1	Oil Felt Wicking, Short
191C1-45	1	Oil Felt Wicking, .187 x .44
201C1-11	1	Eyelet
222C1-7	1	RTV Sealer
300C3-2	4	Screw
302C8-2	1	Screw, Flat Head 4-40 x 3/4
300C10-4	2	Screw, 6-32 x 3/8 Long Round Head
302C10-4	4	Screw, 6-32 x 5/16 Flat Head
305C8-1	7	Screw, 4-40 x 1/4 Binding Head
307C18-1	1	Screw
308C12-1	3	Screw, 8-32 x 3/8 Socket Head
308C14-1	6	Guide Hold Down Screw
309C15-5	3	Guide Adjustment Screw
525C1-4	1	L.H. & R.H. Guides 1-3/4 Stroke
525C1-5	1	L.H. & R.H. Guides 1-1/2 Stroke
525C1-6	1	L.H. & R.H. Guides 1-1/4 Stroke
525C1-7	1	L.H. & R.H. Guides 1-1/8 Stroke
531C1-53	1	Operating Handle
531C1-76*	1	Cushion Grip Handle
579C2-17	1	Cross Head (With Wrist Pin, Lock Washer & Bolt)
580C1-100	1	Switch - Dual-Speed 3-Phase
580C1-198	1	Switch - Single-Speed 1- & 3-Phase
580C1-199	1	Switch - Dual-Speed 1-Phase
607C1-35A	1	Oiling Device, 1-1/8" Stroke
607C1-35B	1	Oiling Device, 1-1/4" Stroke
607C1-35C	1	Oiling Device, 1-1/2" Stroke
607C1-35D	1	Oiling Device, 1-3/4" Stroke
664C1-6	1	Connecting Rod 1-1/8" Stroke
664C1-5	1	Connecting Rod 1-1/4" Stroke
664C1-4	1	Connecting Rod 1-1/2" Stroke
664C1-3	1	Connecting Rod 1-3/4" Stroke
706C1-4	0	Capacitor 110 Volt
706C1-5	0	Capacitor 220 Volt
706C1-13	1	Capacitor 110 Volt
706C1-18	1	Capacitor 220 Volt

CLASS 627
CLASS 629

CLASS 627
CLASS 629

e: Certain 220 volt motors will require these capacitors. Please check capacitor number on label on your machine to order.

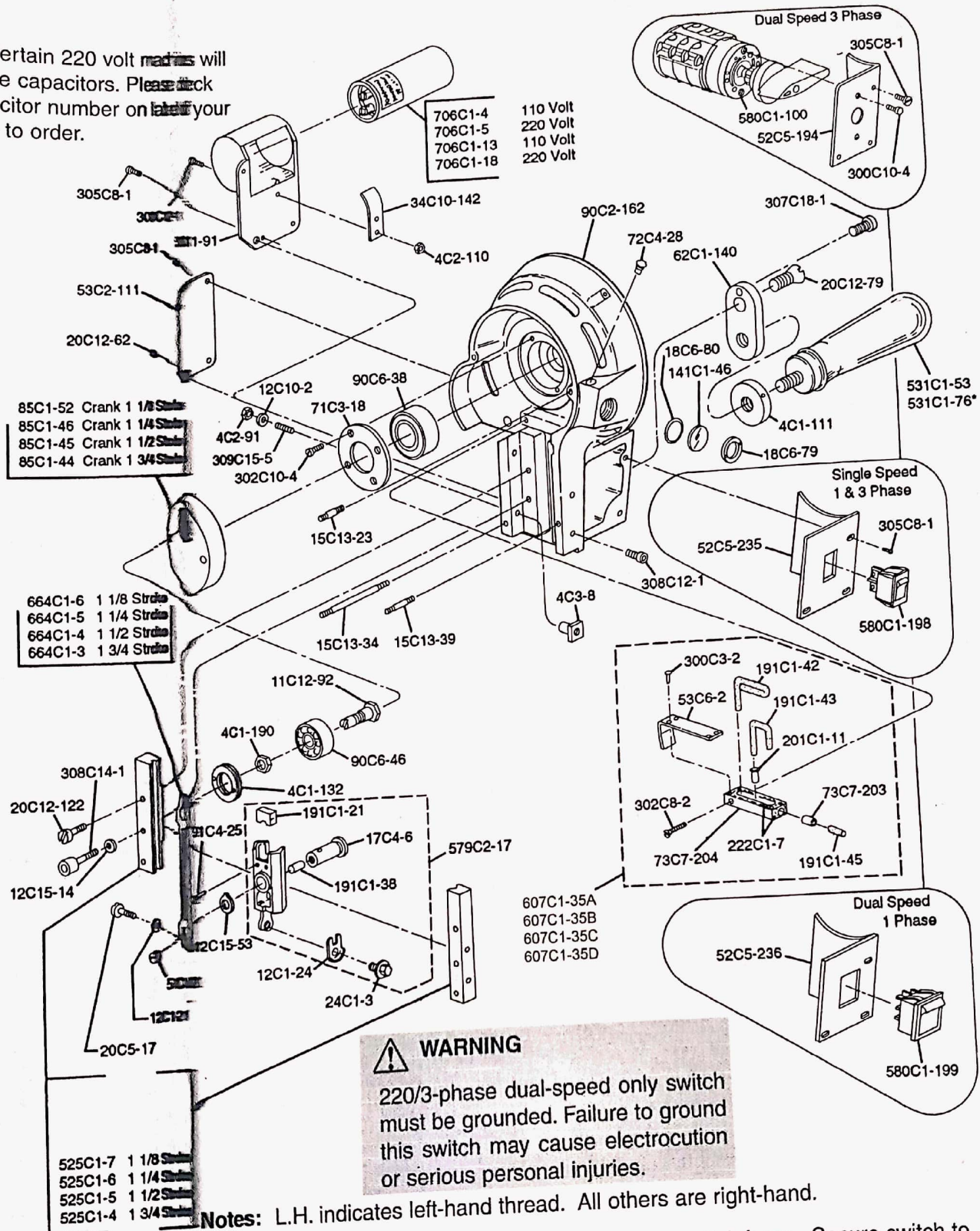

Slip large lug over switch before replacing switch base. Secure switch to base tightly to ensure positive ground.

Fig. 25. Front Bearing Housing with Oiler Assembly (Exploded View)

Eastman machine
COMPANY

Sharpener Housing Assembly

(Front View)

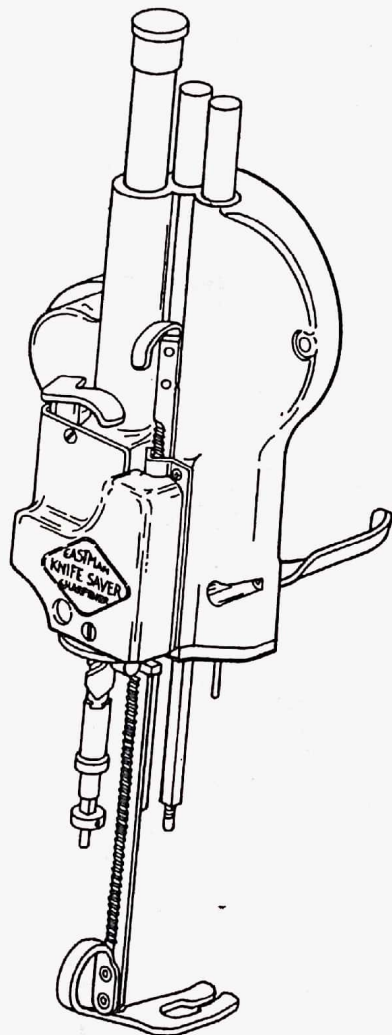

Figure 26. Sharpener Housing Assembly
(Assembled, Front View)

Please specify model and serial number of machine when ordering parts.

Part No.	No. Req'd	Description
	For both 627 & 629	
4C1-149	1	Nut, Elastic
4C1-161	1	Nut, Self Lock
4C2-112	1	R.H. Nut for Screw Shaft
4C2-113	1	L.H. Nut for Screw Shaft
5C5-16	1	Collar, Lower
11C12-54	1	Shaft for Cam
12C15-57	1	Spring Washer for Release Lever
12C15-69	1	Washer for Lock Bracket
12C15-74	4	Washer, Flat
12C15-91	2	Thrust Washer, Upper Nut
17C15-106	1	Roll Pin for Collar
20C4-17	1	Pressure Foot Lever Screw
20C12-13	1	Cam Shaft Spring Screw
20C12-113	1	Screw for Pressure Foot Shoe
20C12-117	2	Screw for Release Lever
20C12-156	1	Screw for Knife Guard Lock
20C12-137	1	Lift Handle for Knife Guard Lock
22C3-2	1	Tension Spring
34C1-20	1	Spring for Pressure Foot Lock
34C8-12	1	Spring for Pressure Foot Lever
34C10-179	1	Spring for Latch
34C10-107	1	Cover for Cam
53C11-72	1	Vinyl Cover for Handle
53C11-103	1	Spacer for Knife Guard Lock Bracket
55C4-49	1	Pressure Foot Shoe, All Strokes
68C1-192	1	Thrust Ball Bearing
71C3-15	3	Cap for Tube
86C7-34	1	Bearing for Cam Shaft
90C4-47	1	Latch for Cam
97C3-35	1	Latch for Cam
147C1-26	1	Extension for Screw Shaft
171C1-16	1	Lock (Only) for Pressure Foot
300C10-1	2	Screw, #6-32 x 3/16 Round Head
300C10-4	4	Screw, #6-32 x 3/8 Round Head
302C10-4	1	Screw, #6-32 x 5/16 Flat Head
302C10-8	1	Screw, #6-32 x 3/4 Flat Head
309C15-7	1	Set Screw for Cam
553C1-7	1	Pressure Foot Lock Bracket Complete
553C1-8	1	Pressure Foot Lock Bracket Only
605C1-36	1	Pressure Foot Rod 7"-8" Knife
605C1-37	1	Pressure Foot Rod 9"-10" Knife
605C1-33	1	Pressure Foot Rod 11-1/2" Knife
605C1-34	1	Pressure Foot Rod 13" Knife
621C1-7	1	Release Lever With Cam
683C1-17	1	Pressure Foot Lever
713C4-4	1	Screw Shaft With Extension, R. & L. Hand Nuts 5"-8"
713C4-5	1	Screw Shaft With Extension, R. & L. Hand Nuts 9"-10"
713C4-6	1	Screw Shaft With Extension, R. & L. Hand Nuts 11-1/2"
713C4-7	1	Screw Shaft With Extension, R. & L. Hand Nuts 13"
732C1-11	1	Sharpener Housing (With Bushings and Tubes) Only 5"-8" Knife
732C1-12	1	Sharpener Housing (With Bushings and Tubes) Only 9"-10" Knife
732C1-20	1	Sharpener Housing (With Bushings and Tubes) Only 11-1/2" Knife
732C1-17	1	Sharpener Housing (With Bushings and Tubes) Only 13" Knife

Sharpener Housing Assembly

(Rear View)

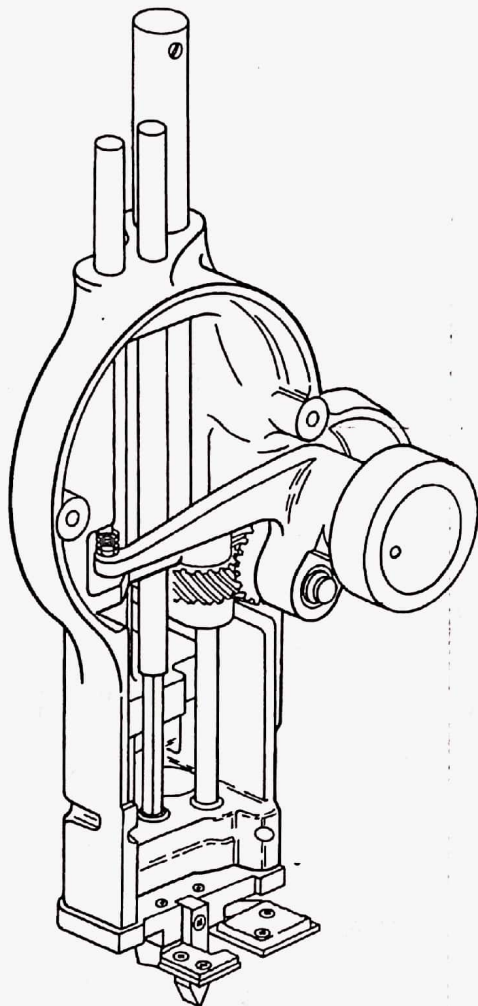
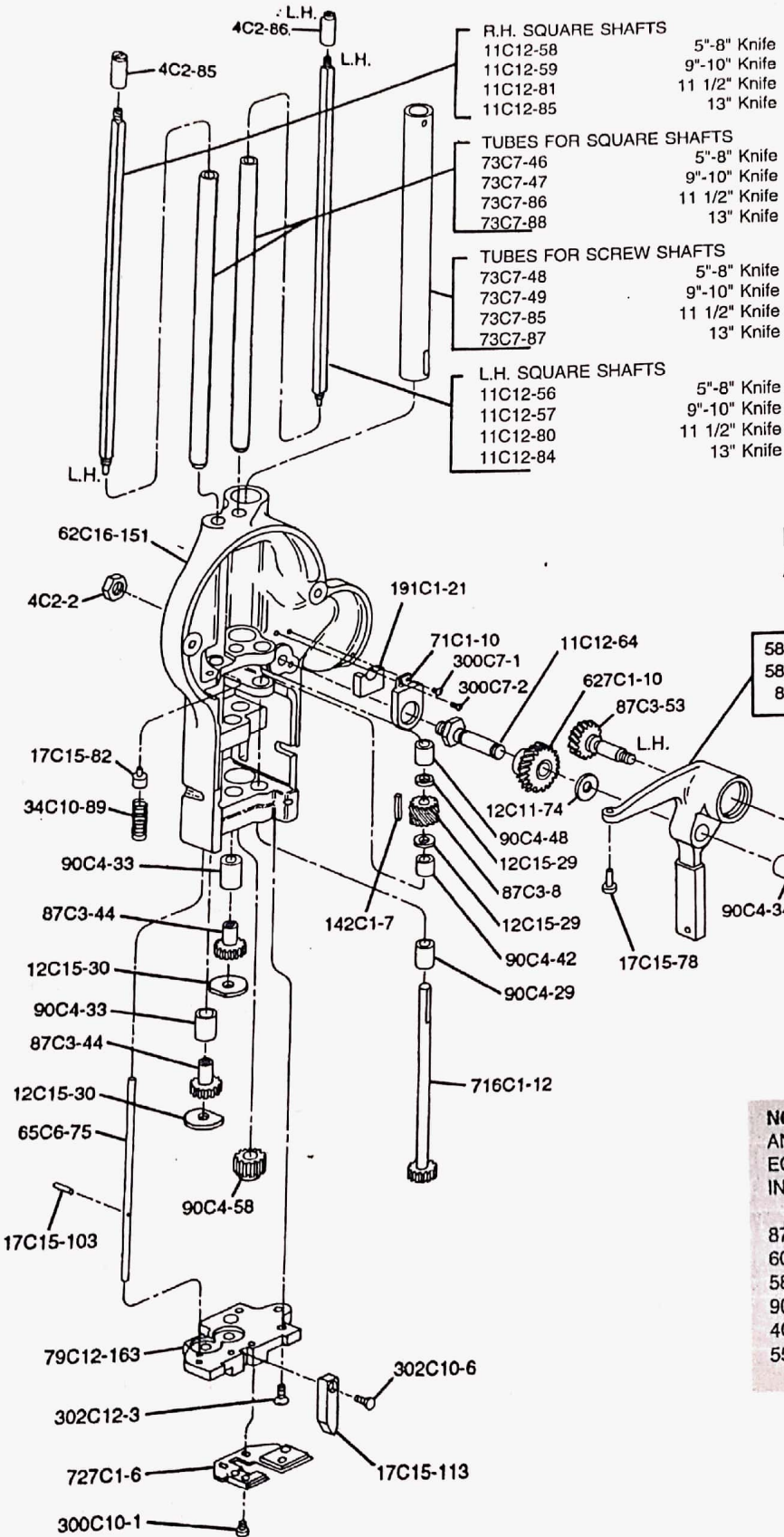

Figure 28. Sharpener Housing Assembly
(Assembled, Rear View)

Note: Please specify model and serial number of machine when ordering parts.

Part No.	No. Req'd	Description
	For both 627 & 629	
4C2-2	1	Lock Nut for Shaft
4C2-85	1	R.H. Follower Nut
4C2-86	1	L.H. Follower Nut
11C12-58	1	R.H. Square Shaft 5"-8" Knife
11C12-59	1	R.H. Square Shaft 9"-10" Knife
11C12-81	1	R.H. Square Shaft 11-1/2" Knife
11C12-85	1	R.H. Square Shaft 13" Knife
11C12-56	1	L.H. Square Shaft 5"-8" Knife
11C12-57	1	L.H. Square Shaft 9"-10" Knife
11C12-80	1	L.H. Square Shaft 11-1/2" Knife
11C12-84	1	L.H. Square Shaft 13" Knife
11C12-64	1	Shaft for Crank
12C11-74	1	Thrust Washer
12C15-29	2	Thrust Washer
12C15-30	2	Thrust Washer for Bottom Plate
17C15-78	1	Pin for Bell Crank
17C15-103	1	Roll Pin for Push Rod
17C15-113	1	Spreader Pin
18C6-81	1	Retaining Ring for Shaft
18C6-26	1	Retaining Ring for Bell Crank
34C10-89	1	Spring for Bell Crank
55C4-41	1	Spacer for Ball Bearings
62C16-151	1	Sharpener Housing (Only)
65C6-75	1	Push Rod
71C1-10	1	Oil Retainer-Idler Gear
73C7-46	1	Tube for Square Shaft 5"-8" Knife
73C7-47	1	Tube for Square Shaft 9"-10" Knife
73C7-86	1	Tube for Square Shaft 11-1/2" Knife
73C7-88	1	Tube for Square Shaft 13" Knife
73C7-48	1	Tube for Screw Shaft 5"-8" Knife
73C7-49	1	Tube for Screw Shaft 9"-10" Knife
73C7-85	1	Tube for Screw Shaft 11-1/2" Knife
73C7-87	1	Tube for Screw Shaft 13" Knife
79C12-163	1	Bottom Plate, Sharpener Housing
85C3-6E	1	Bell Crank (Only)
87C3-8	1	Spiral Gear
87C3-44	2	Spür Gear
87C3-53	1	Gear and Shaft
90C4-29	1	Bearing for Drive Shaft (Lower)
90C4-33	2	Bearing for Gears
90C4-34	1	Bearing for Bell Crank
90C4-42	1	Bearing for Drive Shaft
90C4-48	1	Bearing for Drive Shaft (Upper)
90C4-58	1	Bearing for Screw Shaft
90C6-24	2	Ball Bearing for Crank
142C1-7	1	Key for Gear
191C1-21	1	Felt Pad for Cross Head
300C7-1	1	Screw, #4-36 x 1/8 Round Head
300C10-1	2	Screw, #6-32 x 3/16 Round Head
302C10-6	1	Screw, #6-32 x 1/2 Flat Head
302C12-3	3	Screw, #8-32 x 3/8 Flat Head
584C2-3	1	Bell Crank with Pin & Bearing (Only)
584C3-16	1	Bell Crank Complete with Lever
602C1-7	1	Slow Speed Driver Assembly
602C1-9	1	Driver Pulley with Driver
627C1-10	1	Idler Gear & Bushing
716C1-12	1	Driver Shaft with Gear
727C1-6	1	Oil Pad & Holder



SPACER CHART
For Automatic Sharpeners

STROKE	KNIFE SIZE	SPACER NUMBER	SPACER LENGTH
1 1/8-1 1/4	5	73C7-55	3 7/8
1 1/2-1 3/4	5	73C7-56	4 1/4
1 1/8-1 1/4	6	73C7-57	2 7/8
1 1/2-1 3/4	6	73C7-58	3 1/4
1 1/8-1 1/4	7	73C7-59	1 7/8
1 1/2-1 3/4	7	73C7-60	2 1/4
1 1/8-1 1/4	8	1C13-12	15/16
1 1/2-1 3/4	8	1C13-13	1 1/4
1 1/8-1 1/4	9	73C7-59	1 7/8
1 1/2-1 3/4	9	73C7-60	2 1/4
1 1/8-1 1/4	10	1C13-12	15/16
1 1/2-1 3/4	10	1C13-13	1 1/4
1 1/8-1 1/4	11 1/2	1C13-12	15/16
1 1/2-1 3/4	11 1/2	1C13-13	1 1/4
1 1/8-1 1/4	13	1C13-12	15/16
1 1/2-1 3/4	13	1C13-13	1 1/4

Note: L.H. indicates left-hand thread. All others are right-hand.

- 584C3-16 Bell Crank Complete
- 584C2-3 Bell Crank with Pin & Brg. Only
- 85C3-6 Bell Crank Only

NOTE: FOR SPECIAL SHOES, IF THE MACHINE IS NOT AN 1800 RPM OR A DUAL-SPEED UNIT, IT MUST BE EQUIPPED WITH A #584C3-14 SLOW-SPEED DRIVER, INCLUDING THE FOLLOWING PARTS:

- 87C3-42 Gear Shaft
- 602C1-7 Slow-Speed Driver Ass'y.
- 584C2-1 Bell Crank
- 90C6-24 Ball Bearings
- 4C1-143 Retainer
- 55C4-41 Spacer for Ball Bearings

Figure 29. Sharpener Housing Assembly (Exploded, Rear View)

Eastman machine
COMPANY

Lower Gear Bracket Assembly

Illustrated Parts List

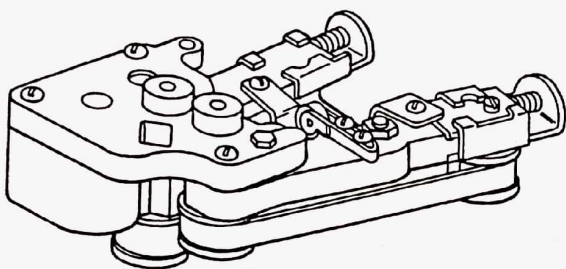

Figure 30. Lower Gear Bracket Assembly (Assembled View)

Complete Sharpener Assembly Numbers: 637C10.*

Height of Machine	Machine Stroke			
	1-1/8"	1-1/4"	1-1/2"	1-3/4"
5"	-20,	-21,	-22,	-23,
6"	-24,	-25,	-26,	-27,
7"	-28,	-29,	-30,	-31,
8"	-32,	-33,	-34,	-35,
9"	-36,	-37,	-38,	-39,
10"	-40,	-41,	-42,	-43,
11-1/2"		-45,	-46,	-47,
13"	-48,	-49,	-50,	-51

Part No.	No. Req'd	Description
4C1-189	1	Jam Nut, #8-32
4C2-63	2	Nut for Sharpener Shoe Screw
12C15-93	4	Washer, Shoe
17C15-106	2	Roll Pin (For Pulley 152C1-19)
20C6-25	1	Adjusting Screw
20C12-57	2	Screw for Sharpener Shoe (Wave Knife Only)
20C12-143	1	Screw for Clamping Arm
20C12-153	2	Screw for Sharpener Shoe
21C14-14	2	Bushing for Sharpener Shoe
34C10-45	2	Spring for Pulley Slide
34C10-47	1	L.H. Sharpener Shoe Spring (Wave Knife Only)
34C10-57	1	R.H. Sharpener Shoe Spring (Wave Knife Only)
34C10-123	1	Spring for Arm

Part No.	No. Req'd	Description
34C10-148	1	L.H. Sharpener Shoe Spring
34C10-149	1	R.H. Sharpener Shoe Spring
35C7-28	1	Clamping Arm for Shoe
53C4-78	1	Gear Cover
54C4-35	1	Oil Hole Plug
62C6-31	1	Bracket, Lower Gear
70C4-32	1	Guide Back of Standard
79C12-219	2	Wear Plate
87C3-50	1	Gear on Screw Shaft
87C5-13	1	Intermediate Gear
90C4-47	1	Bearing for Intermediate Gear
90C4-51	1	Bearing for Screw Shaft
90C4-59	2	Bearing for Shaft Extension
147C1-28	1	R.H. Shaft Extension
147C1-29	1	L.H. Shaft Extension
152C1-19	2	Front Pulley for Belt
209C1	2	Neoprene Band for Pulley
300C7-3	4	Screw, #4-36 x 1/4 Round Head
300C10-2	2	Screw, #6-32 x 1/4 Round Head
300C10-6	3	Screw, #6-32 x 1/2 Round Head
301C7-2	2	Screw, #4-36 x 3/16 Fillister Head
301C10-3	1	Screw, #6-32 x 3/8 Fillister Head
309C12-2	1	Stop Screw, L.H. Shoe
712C1	1	R.H. Slide with Pulley
712C1-1	1	L.H. Slide with Pulley
715C1-19	1	Lower Gear Bracket with Cover Brgs., Screws & Wear Plate
715C1-23	1	5"-13" Knife
728C1-5	2	Lower Gear Bracket (Complete)
743C1-26	1	Stabilizer Assembly
743C1-27	1	R.H. Shoe (Wave Knife Only)
743C1-28	1	L.H. Shoe (Wave Knife Only)
743C1-29	1	R.H. Pre-set Sharpener Shoe (Only)
820C1-7	1	L.H. Pre-set Sharpener Shoe (Only)
820C1-8	1	L.H. Complete Shoe Assembly
		R.H. Complete Shoe Assembly

Note: Please specify model and serial number of machine when ordering parts.

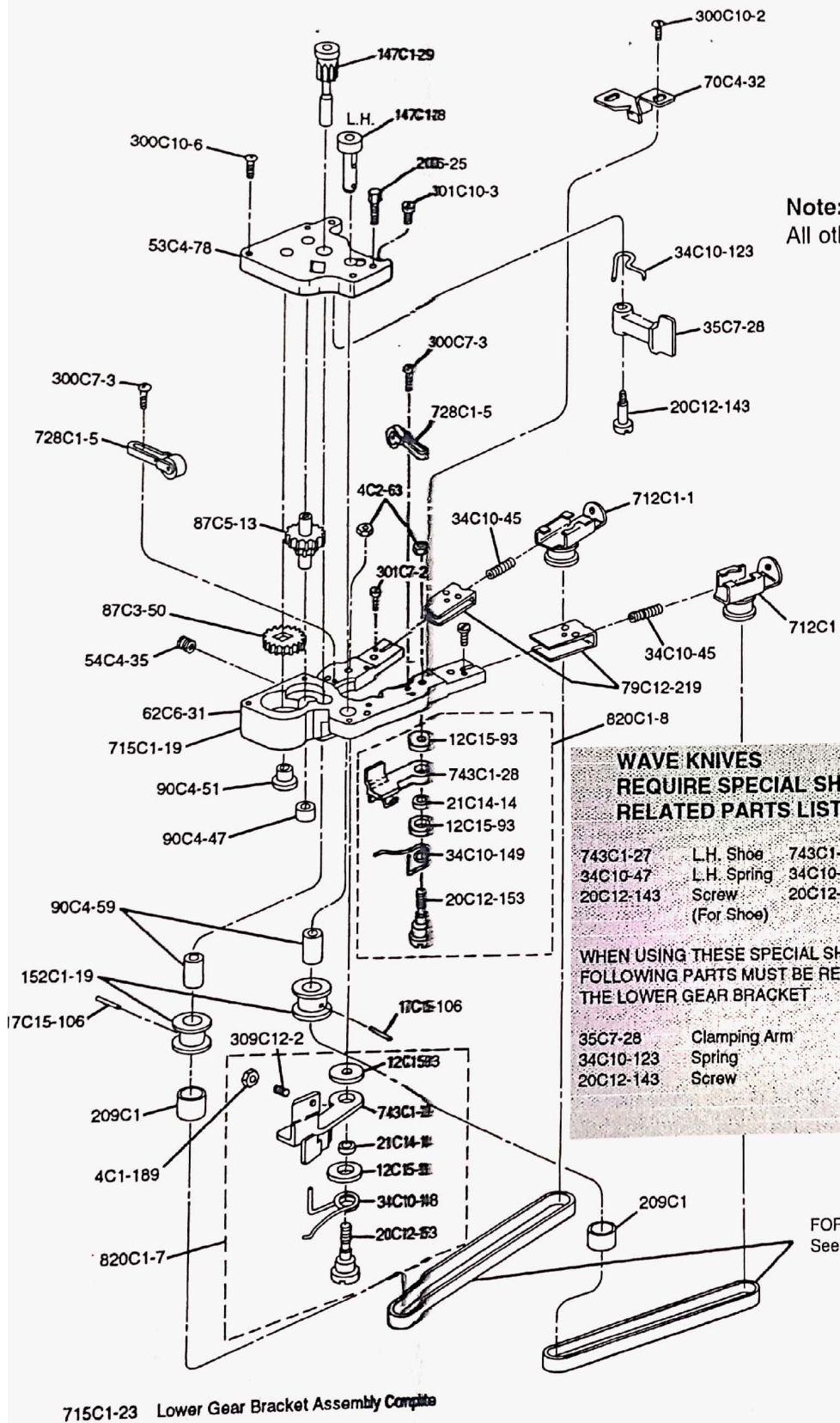

Note: L.H. indicates left-hand thread. All others are right-hand.

WAVE KNIVES REQUIRE SPECIAL SHOES AND RELATED PARTS LISTED BELOW

743C1-27	L.H. Shoe	743C1-26	R.H. Shoe
34C10-47	L.H. Spring	34C10-57	R.H. Spring
20C12-143	Screw (For Shoe)	20C12-57	Screw (For Shoe)

WHEN USING THESE SPECIAL SHOES THE FOLLOWING PARTS MUST BE REMOVED FROM THE LOWER GEAR BRACKET

35C7-28	Clamping Arm
34C10-123	Spring
20C12-143	Screw

FOR BELT LISTING See Page 18

715C1-23 Lower Gear Bracket Assembly Complete

Figure 31. Lower Gear Bracket Assembly (Exploded View)

Eastman machine
COMPANY

Standard and Baseplate Assembly

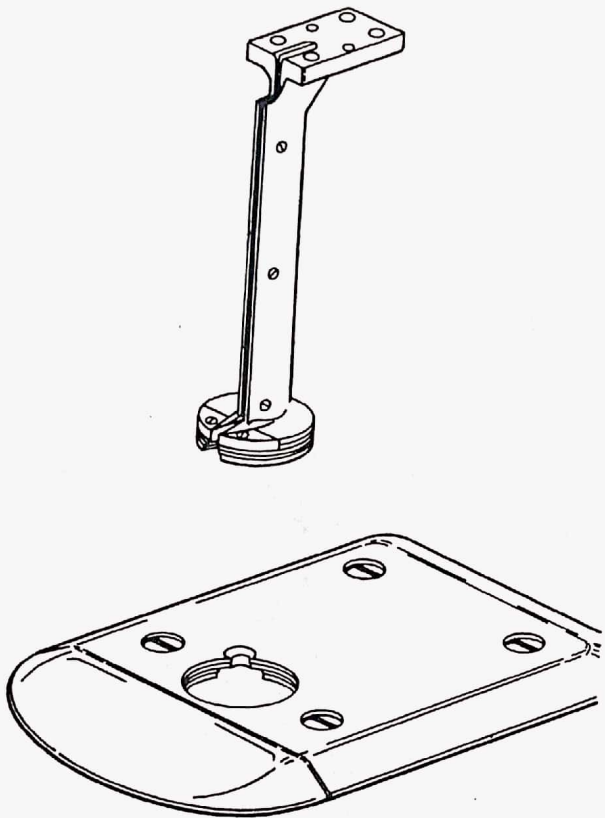

Figure 32. Standard and Baseplate Assembly
(Assembled View)

Note: Please specify model and serial number of machine when ordering parts.

Part No.	No. Req'd	Description
	For both 627 & 629	
12C1-35	4	Lock Washer, #8
12C15-77	1	Washer for Micro Fog Standard
17C1-4	2	Taper Pin #0 x 3/4
17C6-9	2	Hinge Pin
20C5-12	8	Clamp Screw for Rollers
20C12-19	1	Knife Slide Screw
20C13-51	4	Hinge Pin Clamp Screw
34C1-57	2	Plate Wing Tension Spring
60C1-55	1	Plate Wing (For Small Plates)
60C1-56	1	Plate Wing (For Large Plates)
79C4-12	1	Throat Plates with Screws and Pins
79C4-24	1	Tapered & Relieved Throat Plates Assembly
213C1-1	6	Fibre Shirm
302C12-3	3	Screw, #8-32 x 3/8 Flat Head
505C3-223	1	Small Plate Base Complete (5"-8" Knife)
505C3-224	1	Large Plate Base Complete (9"-13" Knife)
505C3-226	1	Small Plate Base Complete (5"-8" Knife)
505C3-227	1	For 50 Cycle 1500 R.P.M. & Dual-Speed Only Large Plate Base Complete (9"-13" Knife)
505C3-243	1	For 50 Cycle 1500 R.P.M. & Dual-Speed Only Small Plate Base Complete (5"-8" Knife)
505C3-244	1	Used with Swivel Roller Assembly Only Large Plate Base Complete (9"-13" Knife)
528C1-112	1	Used with Swivel Roller Assembly Only Micro Fog Standard (Complete with Slides and Throat Plates) 6" Knife
528C1-123	1	Standard (Complete with Slides and Throat Plates) 5" Knife
528C1-120	1	Standard (Complete with Slides and Throat Plates) 6" Knife
528C1-122	1	Standard (Complete with Slides and Throat Plates) 7" Knife
528C1-121	1	Standard (Complete with Slides and Throat Plates) 8" Knife
528C1-115	1	Standard (Complete with Slides and Throat Plates) 9" Knife
528C1-116	1	Standard (Complete with Slides and Throat Plates) 10" Knife
528C1-124	1	Standard (Complete with Slides and Throat Plates) 11-1/2" Knife
528C1-125	1	Standard (Complete with Slides and Throat Plates) 13" Knife
532C2-3	4	Rubber Mounted Roller (Complete)
532C2-5	4	Rubber Mounted Roller (Complete)
532C2-7	4	Rubber Mounted Roller (Complete)
619C1-31	4	Roller Shell (Complete)
643C1-44	1	Knife Slides (Complete with Screws) 5" Knife
643C1-41	1	Knife Slides (Complete with Screws) 6" Knife
643C1-42	1	Knife Slides (Complete with Screws) 7" Knife
643C1-43	1	Knife Slides (Complete with Screws) 8" Knife
643C1-46	1	Knife Slides (Complete with Screws) 9" Knife
643C1-47	1	Knife Slides (Complete with Screws) 10" Knife
643C1-53	1	Knife Slides (Complete with Screws) 11-1/2" Knife
643C1-45	1	Knife Slides (Complete with Screws) 13" Knife
643C1-51	1	Knife Slides (Complete with Screws) 6" Micro Fog
619C1-32	2	Swivel Roller Assembly

**INSTRUCTIONS
FOR REMOVING WORN
PLATE ROLLER SHELL**

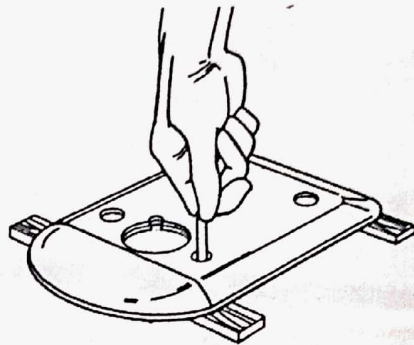
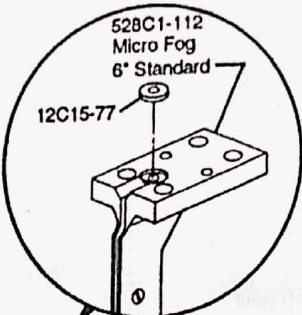

Figure 34. Removing a Worn Plate Roller Shell

STANDARDS COMPLETE W/SLIDES

528C1-123	5" Standard
528C1-120	6" Standard
528C1-122	7" Standard
528C1-121	8" Standard
528C1-115	9" Standard
528C1-116	10" Standard
528C1-124	11-1/2" Standard
528C1-125	13" Standard



KNIFE SLICES

643C1-44	5" Knife
643C1-41	6" Knife
643C1-42	7" Knife
643C1-43	8" Knife
643C1-46	9" Knife
643C1-47	10" Knife
643C1-53	11-1/2" Knife
643C1-45	13" Knife
643C1-51	6" Micro Fog

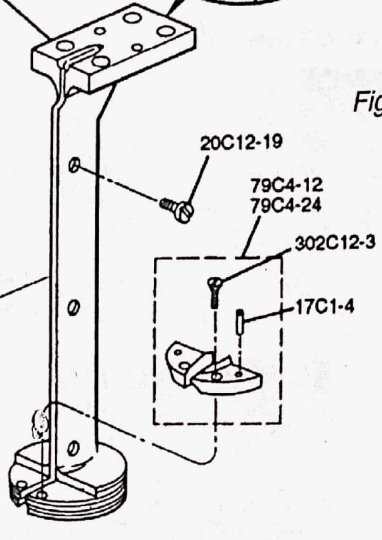

CAUTION
Do not oil the plate roller shells or you may damage them.
Place the plate on blocks and press out the roller shell from the ring assembly (Figure 34).

NOTE: A roller shell (complete with shaft and bearings) may be ordered as required. Specify part number 619C1-30.

To install a new roller shell, invert the baseplate and press the roller shell into the ring assembly.

OPTIONAL

*619C1-32	Swivel Roller Assembly
532C2-3	Rubber Mounted Wide Roller
532C2-5	Rubber Mounted Roller (For All Machines Except Noted Below)
532C2-7	Rubber Mounted Roller (For 50 Cycle 1500 R.P.M. and Dual Speed Machines Only)
505C3-223	Small Plate for 5"-8" Knives
505C3-224	Large Plate for 9"-13" Knives
FOR 50 CYCLE 1500 R.P.M. & DUAL SPEED MACHINES ONLY	
505C3-226	Small Plate for 5"-8" Knives
505C3-227	Large Plate for 9"-13" Knives
FOR PLATES WITH SWIVEL ROLLERS	
505C3-243	Small Plate for 5"-8" Knives
505C3-244	Large Plate for 9"-13" Knives

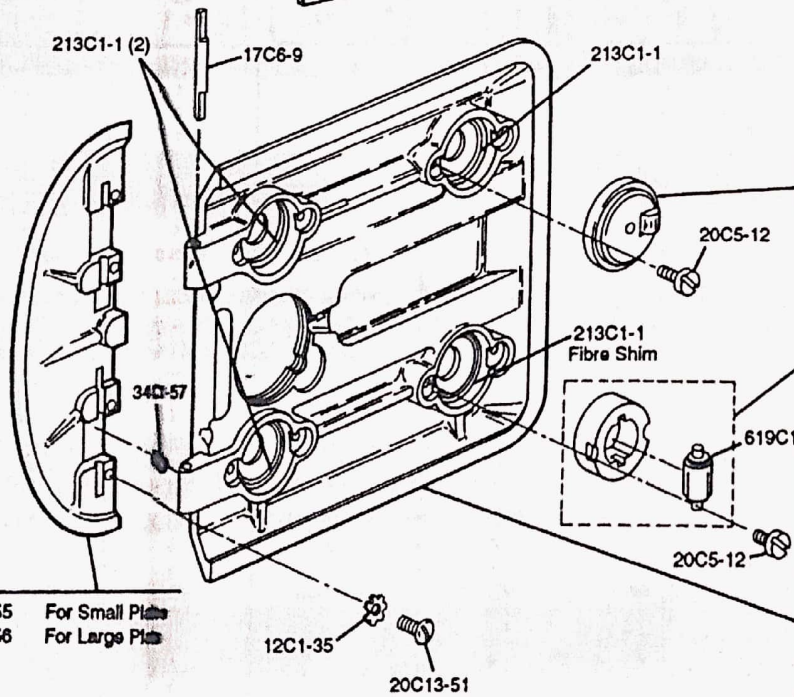

Figure 33. Standard and Baseplate Assembly (Exploded View)

**Eastmanmachine
COMPANY**